



deltec
homes



DELTEC HOMES

Founded in 1968, Deltec Homes is a family-owned company based out of Asheville, North Carolina. For 50 years, we've designed and prefabricated our homes to protect you and your family while creating a welcoming, comfortable and healthy environment. The moment you step into one of our flagship round homes, you'll experience a relaxing escape from our increasingly busy world.

Throughout your project, you'll see that our commitment to excellence, the environment and our customers drives us to exceed expectations.





ENERGY EFFICIENCY

BUILDING GREEN
BEFORE IT WAS TRENDY

The precise construction, airtight building envelope and round shape means energy efficiency is inherent with every Deltec home. We also offer a range of upgrades and design strategies to increase efficiency even more, all the way to net-zero. In fact, the average Deltec home is about 53% more efficient than typical new construction, as verified through the RESNET HERS program. The reduced air-leakage will not only save you money each month, but means more consistent indoor temperatures and fewer allergens, keeping you and your family healthy.

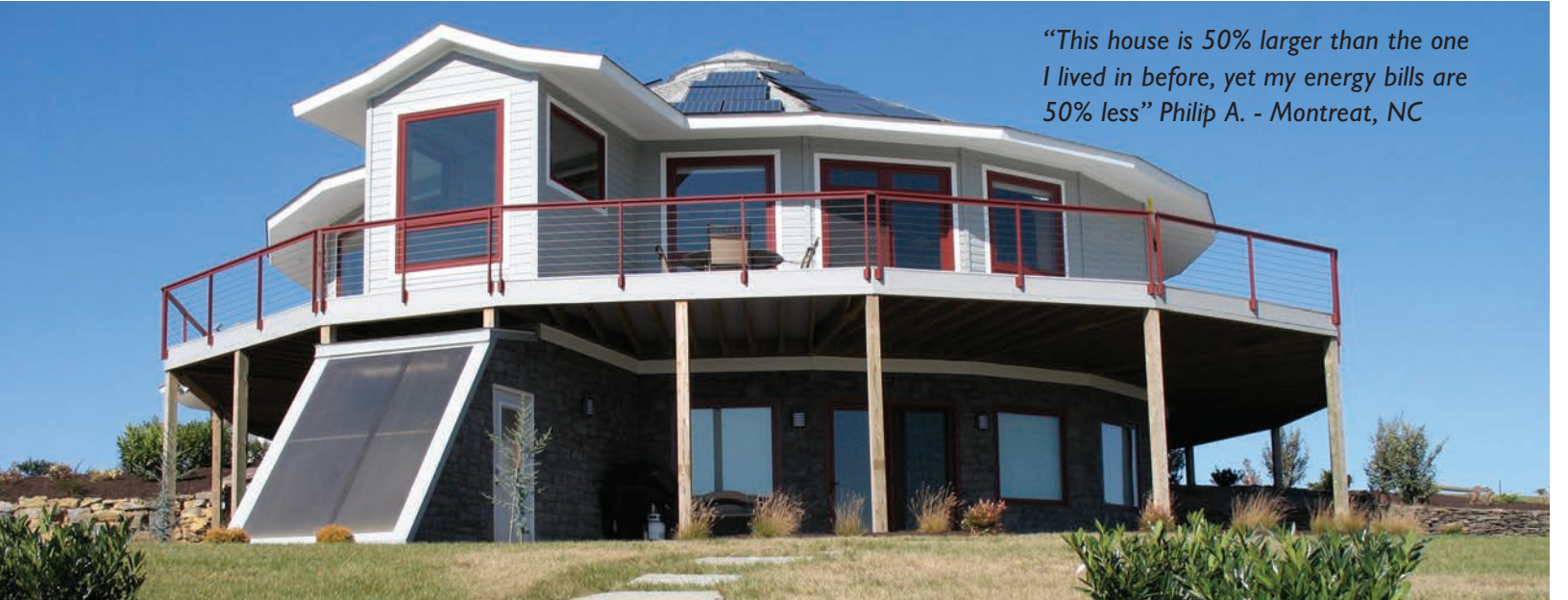

“This house is 50% larger than the one I lived in before, yet my energy bills are 50% less” Philip A. - Montreat, NC

Environmental responsibility has been the core of our company for 50 years. Every component of your home—from building materials to building methods—is focused on sustainability. With 273 solar panels on the roof of our production facility, every home is prefabricated using 100% renewable energy. We also divert 80% of construction waste away from landfills by regularly donating scrap wood to non-profits.

SUSTAINABLE BUILDING

BUILT RESPONSIBLY
FROM START TO FINISH

273 solar panels on the roof of our production facility



“Deltec is at the national forefront in the industry, setting an example for us all to reduce our environmental footprint, cut our energy bills, and come home to a healthier place to live.”

US Green Building Council President, CEO and Founding Chair Rick Fredrizzi

PRECISION CRAFTSMANSHIP

UNMATCHED QUALITY

Our method of building combined with the highest grade material ensure unparalleled quality. Every home is precision crafted to exacting standards in a climate controlled environment. Building each panel of the structural shell at waist level, away from the elements, allows us to put immense focus on details that can't be fixed later. In addition, we use lumber that is twice as strong as typical framing material, providing you with a home that is not only more durable, but requires much less maintenance.



"You can tell it is very solidly built. We always say 'this house is a tank', yet it has that light, airy feel we were looking for" Rick & Maureen W. - Asheville, NC

Deltec homes are designed to work with nature, rather than against it. The aerodynamic shape, material quality and advanced engineering are just some of the factors that make our round homes hurricane resistant. We've seen Deltecs stand up against some of the most detrimental storms in history including direct hits from Hurricanes Irma, Harvey, Sandy, Katrina, Hugo, Ivan and Charley. Our track record speaks for itself: if you're in a coastal area, our hurricane resistant design will perform far better than conventional construction.

HURRICANE RESISTANT

BUILT TO PROTECT
YOUR FAMILY

"Having experienced four hurricanes in five years, two of which were category four or higher, with absolutely no damage, I can truly attest to the quality of engineering and structural integrity of a Deltec home." James S. - Abaco, Bahamas



PANORAMIC VIEWS

BRING THE OUTDOORS IN

If you have a great view, there is no better way to capture it than with a round home. In addition to the shape, our wide variety of window options allow you to create panoramic views that can be enjoyed anywhere in the home.



“The design provides a complete unobstructed panoramic view. It fits so perfectly in its surroundings, it’s as though it came from and is part of nature itself.” Sheldon H. - Lake Martin, AL

Our self-supported roof system means there are no load bearing walls. Therefore, floorplans can be completely customized. With 10 sizes of round models and several wing and connect options, there's almost no limit to how you can mix and match our structures. In fact, we did the math and there are over 1.8 million possible combinations! See page 11 for model size information.

CUSTOM FLOORPLANS

TOTAL INTERIOR FLEXIBILITY



LOW COST OF OWNERSHIP

SAVE MONEY OVER TIME

As the saying goes, you get what you pay for. With Deltec, you're getting a low-maintenance home that offers superior quality, durability and healthier living conditions, all while drastically lowering energy usage. So while the upfront cost is typically about 4-8% more, the cost over time is significantly less.

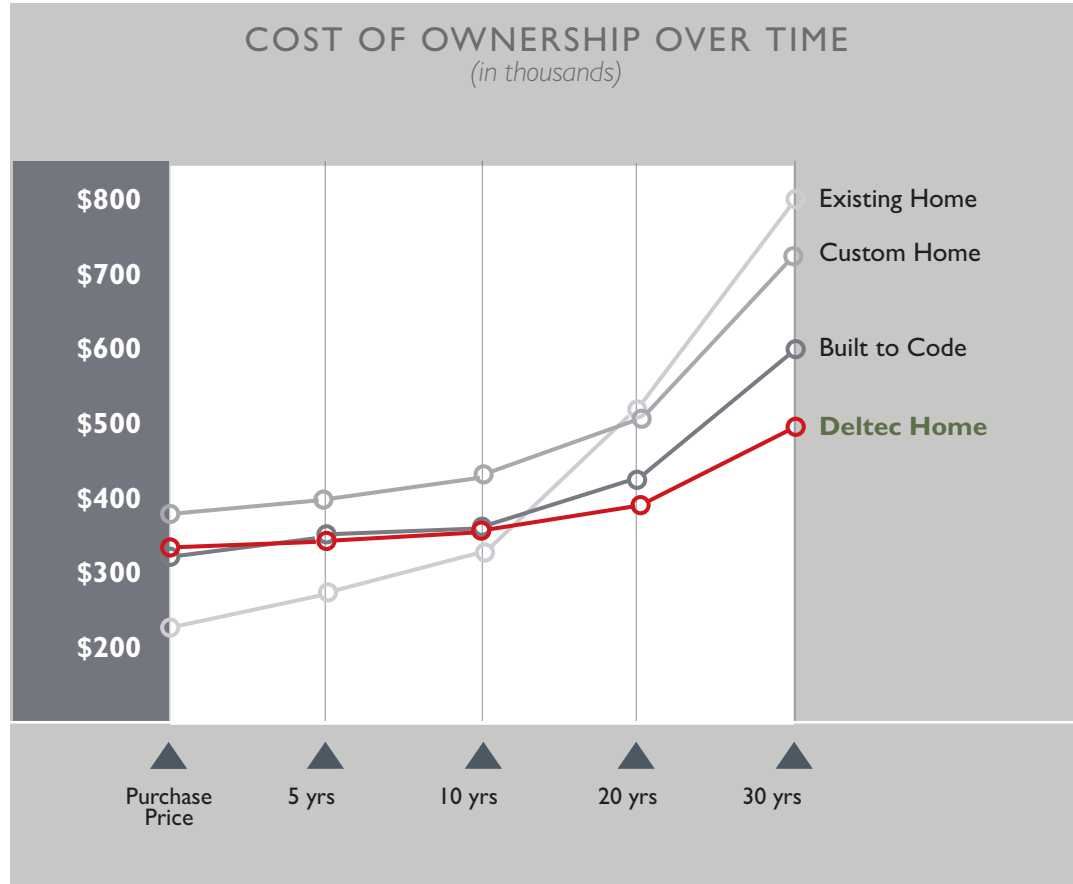

*“Building energy-smart is much cheaper in the long run. A lot of builders aren’t adapting and using old technology. You need to be really educated and improve on the status quo.”
Deltac homeowner Chris S. - Bellafonte, PA*

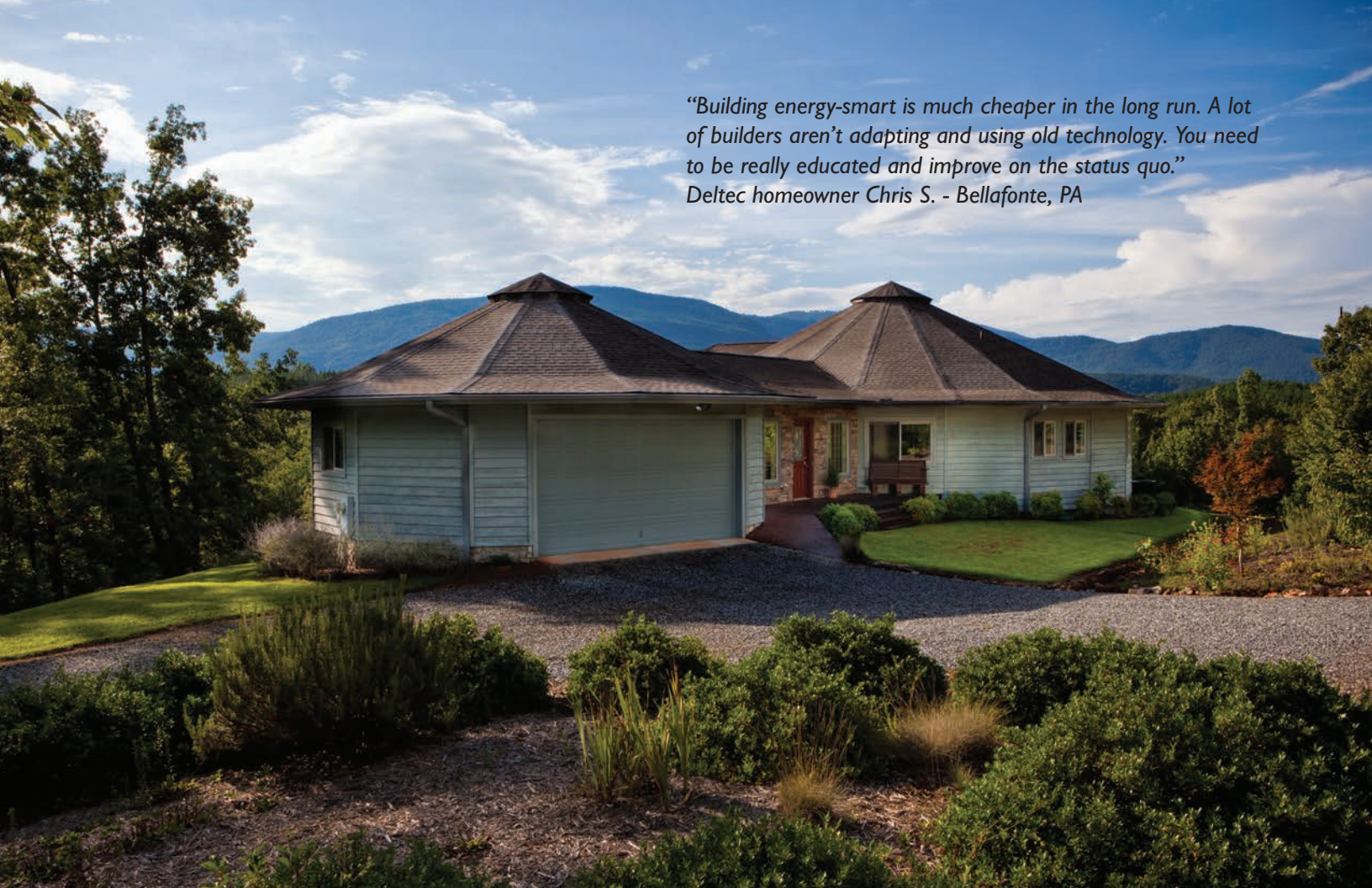

MODEL SELECTIONS

1.8 MILLION POSSIBLE
COMBINATIONS

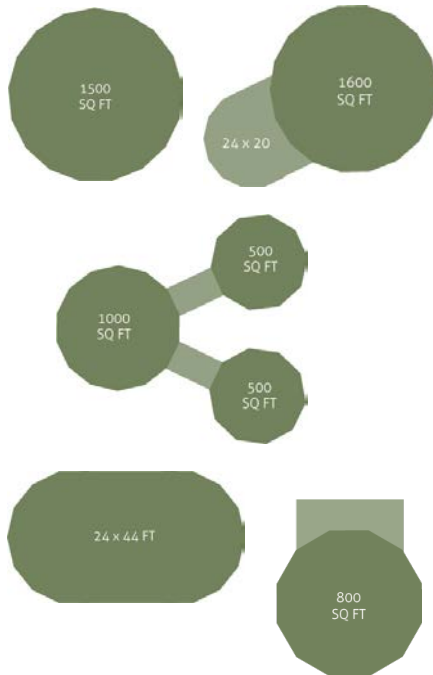

Choose one of our ten round models or our Crescent Chalet for the main structure. Each can be up to three stories. We also have several wing and connect options that can be added to for even more space. This is a great option for a garage, bonus room or to connect multiple round structures together.

Model Size	#of Sides	Diameter in ft.	1 Story sq. ft.	2 Story sq. ft.	3 Story sq. ft.
2500	22	56	2503	5006	7509
2000	20	52	2070	4140	6210
1600	18	47	1680	3360	5040
1500	17	45	1496	2992	4488
1200	15	39	1165	2330	3495
1000	14	37	1017	2034	3051
900	13	34	876	1752	2628
800	12	32	746	1492	2238
500	10	26	517	1034	1551
300	8	22	328	656	N/A
CRESCENT CHALET	—	—	Variable from 912 sq. ft. up	Variable from 1824 sq. ft. up	Variable from 2736 sq. ft. up
WINGS	Available 16', 24', 28' widths, in square or crescent end. Lengths available in 2' increments.				
GARAGES	Available in circular, square or rectangular design				
CONNECTORS	Available 8', 12', 16', 24', 28' widths. Lengths available in 2' increments.				
Diameters and areas shown are approximate					

When you purchase a Deltec, you're getting a panelized structural shell, which includes the roof system, wall system and floor system. We have hundreds of options you can add to your shell such as pre-painted and pre-installed siding, pre-installed windows, metal roof, wall upgrades, deck packages and many more. Your Project Manager will help you select the options that make the most sense for your project.

STANDARD SHELL AND OPTIONS

WE START WITH THE BASICS



*Images left & below: interior & exterior examples of what is included with the basic shell. Typically, our homeowners choose to add some of the options listed above to make completing the home onsite even more streamlined. *Note that the image below does not show our included roof wrap.*



FIVE STEP PROCESS

WE MAKE IT EASY

Our goal is to make your building process as easy as possible, so your Project Manager is there to assist you every step of the way, even after your home is delivered. Some of the items we'll help you with are:

- Finding a builder
- Selecting a bank (if financing)
- Permitting
- Green building certifications
- Builder support with 24-hour access to our in-house construction expert



1 Step One: Getting Started Place your initial deposit towards the purchase of your Deltec home and start working with your project manager.



2 Step Two: Team Work Your personal project manager will guide you through the planning phase and work with you to finalize your home options, floorplan and features.

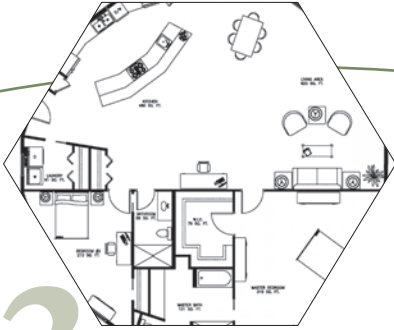

3 **Step Three: Design**

Finalized Once you have made final option choices and approved your home's floorplan, production is scheduled. This typically occurs about 8 weeks prior to your intended delivery date.



4 **Step Four: Production**

Begins Fabrication of your new home begins in our facility. Once finished, your home package is ready for delivery to your jobsite.



5 **Step Five: Delivery**

Your home is delivered and can typically be dried in within 5-7 days. Your builder then completes the interior like a site-built home.

When should you start? Once onsite, construction of a Deltec is typically much faster than traditional building. Since our production schedule is first come, first serve, we recommend starting the design process at least one year prior to your goal move-in date.



**deltec
homes**



69 Bingham Road Asheville, NC 28806

800.642.2508

deltechomes.com

